

NL-JO Internal pipe lifting holder with lining



CE Declaration of conformity

2006/42/EC manufactured according to Directive

EN 13155 meets the Standard

-20 +60°C working temperature

16 000 max. working cycles **strength test** 100% according to PN-EN 13155

Made in EU



Lining made of polyamide

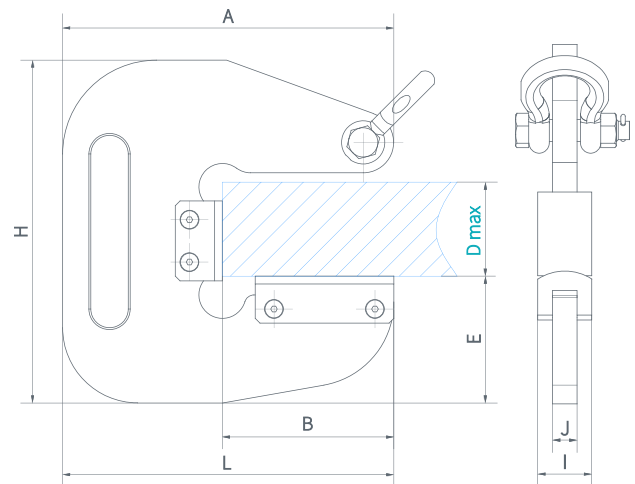

The handles are designed to work in pairs

Code	WLL/pair [kg]	Dimensions [mm]								Mass [kg]
		L	A	B	D max	E	H	I	J	
NL-JO 6.0	6 000	353	353	182,5	100	135	365	55	25	17,5
NL-JO 10.0	10 000	470	470	265	150	175	485	60	35	44

NL-M Automatic clamp for I-beams



CE Declaration of conformity

2006/42/EC manufactured according to Directive

EN 13155 meets the Standard

-20 +100°C working temperature

16 000 max. working cycles **strength test** 100% according to PN-EN 13155

Made in EU

•The clamp is equipped with an automatic lock

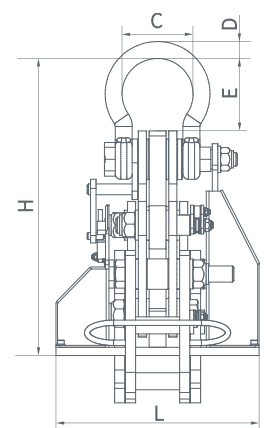
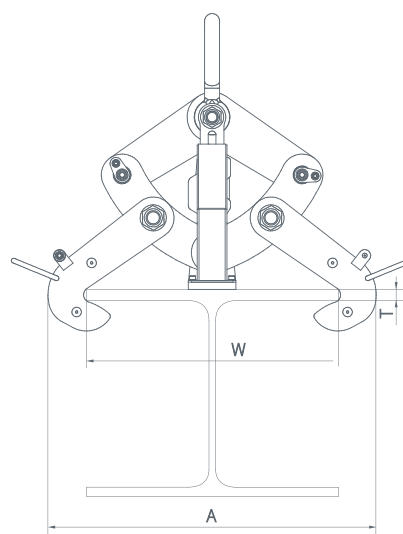

Code	WLL [kg]	Gripping range W [mm]	Dimensions [mm]							Mass [kg]
			A	H	T	C	D	E	L	
NL-M 5.0	5 000	100 - 260	299 - 431	439	6,5 - 25	57	22,5	107	300	42