

## NL-P Rectangular profile clamp

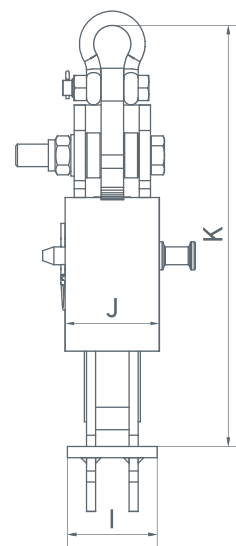

Declaration of conformity  
 2006/42/EC manufactured according to Directive  
 EN 13155 meets the Standard  
 -20 +100°C working temperature  
 16 000 max. working cycles  
 strength test 100% according to PN-EN 13155  
 Made in EU

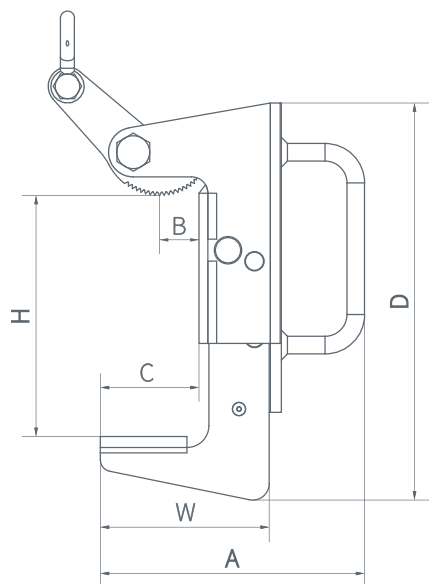

Code	WLL [kg]	Gripping range H [mm]	Dimensions [mm]								Mass [kg]
NL-P 0.7-220	700	150, 160, 180, 200, 220	A	W	B	C	D	I	J	K	
			241	154	36	90	362	80	84	375	10

## NL-R Automatic round profile clamp



Declaration of conformity  
 2006/42/EC manufactured according to Directive  
 EN 13155 meets the Standard  
 -20 +100°C working temperature  
 16 000 max. working cycles  
 strength test 100% according to PN-EN 13155  
 Made in EU

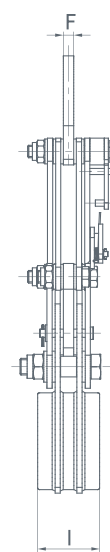
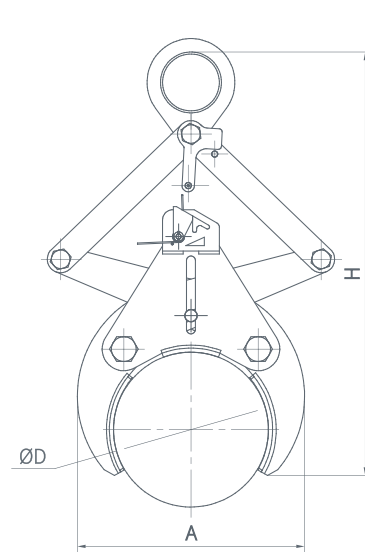

Code	WLL [kg]	Gripping range ØD [mm]	Dimensions [mm]				Mass [kg]
NL-R 0.5	500	90 - 150	A	H	I	F	
NL-R 1.0	1 000	140 - 225	192 - 235	363 - 519	60	10	5,5
			270 - 320	531 - 713	80	15	16